

NOTES:

1) CLOSED CELL EPDM SPONGE RUBBER (0.380 G/CM³)

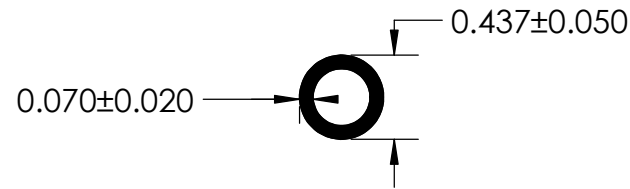
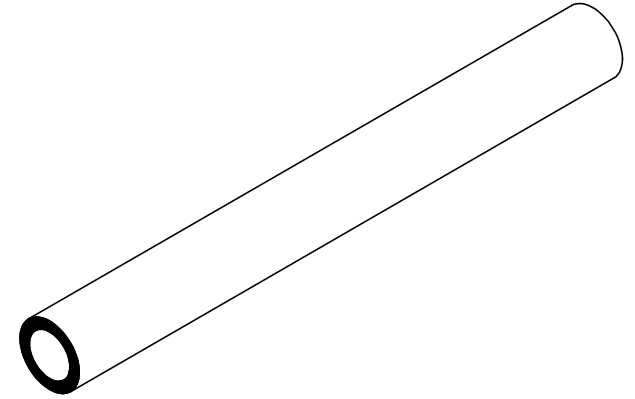

UNI-GRIP, INC.

9823 STATE ROUTE 53 N
UPPER SANDUSKY, OHIO 43351

| REVISION BLOCK | | | | PROPRIETARY AND CONFIDENTIAL: | UNLESS OTHERWISE SPECIFIED: | TITLE: | | | | |
|--|------|-------------|--------------|---|---|-------------|----------|-------------|-----------|--------------|
| REV. | DATE | REVIEWED BY | CHANGES MADE | THE INFORMATION CONTAINED IN THIS DRAWING IS THE SOLE PROPERTY OF UNI-GRIP, INC. ANY REPRODUCTION IN PART OR AS A WHOLE WITHOUT THE WRITTEN PERMISSION OF UNI-GRIP, INC. IS PROHIBITED. | DIMENSIONS ARE IN INCHES TOLERANCES PER ARPM CLASS 3 | .437 BULB | | | | |
| A | | | | | | | | | | |
| B | | | | | WEIGHT | 0.019 LB/FT | | | | |
| C | | | | | ASTM D1056 | 2A4 | SIZE | DWG. NO. | REV | |
| D | | | | | DOCUMENT CONTROL NUMBER | ASTM D2000 | A | UG-1-BL-071 | A | |
| E | | | | UG-1-EN-001-FR-(103018) | N/A | | | | | |
| P:\Engineering\Prints\Bulb Seals\.437 BULB UG-1-BL-071 | | | | SCALE: | 1:1 | DR. BY | C. VENT | DATE | 9/18/2019 | SHEET 1 OF 1 |