

NOTES:

1) CLOSED CELL EPDM SPONGE RUBBER (0.550 G/CM³)

2) 3/4" ST-1200 3M HEAT ACTIVATED TAPE (0.013 LB/FT)

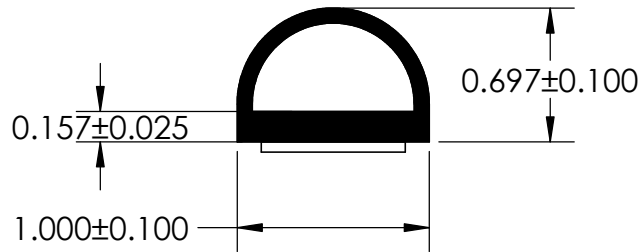
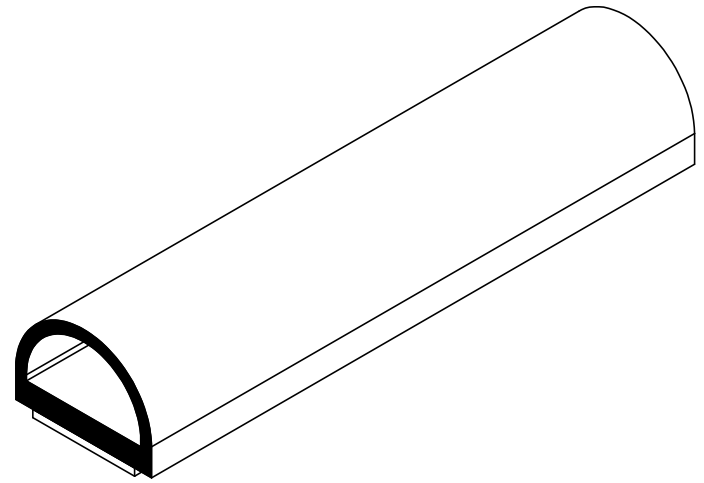

UNI-GRIP, INC.

9823 STATE ROUTE 53 N
UPPER SANDUSKY, OHIO 43351

REVISION BLOCK				PROPRIETARY AND CONFIDENTIAL:	UNLESS OTHERWISE SPECIFIED:	TITLE:		
REV.	DATE	R. By	CHANGES MADE	THE INFORMATION CONTAINED IN THIS DRAWING IS THE SOLE PROPERTY OF UNI-GRIP, INC. ANY REPRODUCTION IN PART OR AS A WHOLE WITHOUT THE WRITTEN PERMISSION OF UNI-GRIP, INC. IS PROHIBITED.	DIMENSIONS ARE IN INCHES TOLERANCES PER ARPM CLASS 3	TS-206		
A								
B					WEIGHT	DWG. NO.		
C					0.083 LB/FT			
D					ASTM D1056	2A5	A	UG-1-TS-750-TP-206
E				ASTM D2000	N/A			
DOCUMENT CONTROL NUMBER				UNLESS OTHERWISE SPECIFIED:	SCALE:	DR. BY	DATE	SHEET
UG-1-EN-001-FR-(080918)				UNLESS OTHERWISE SPECIFIED:	1:1	C. VENT	10/11/2021	1 OF 1
P:\Engineering\Prints\Master Prints\Tape Seals\TS-206 UG-1-TS-750-TP-206								